

PRODUCT CONFIGURATION

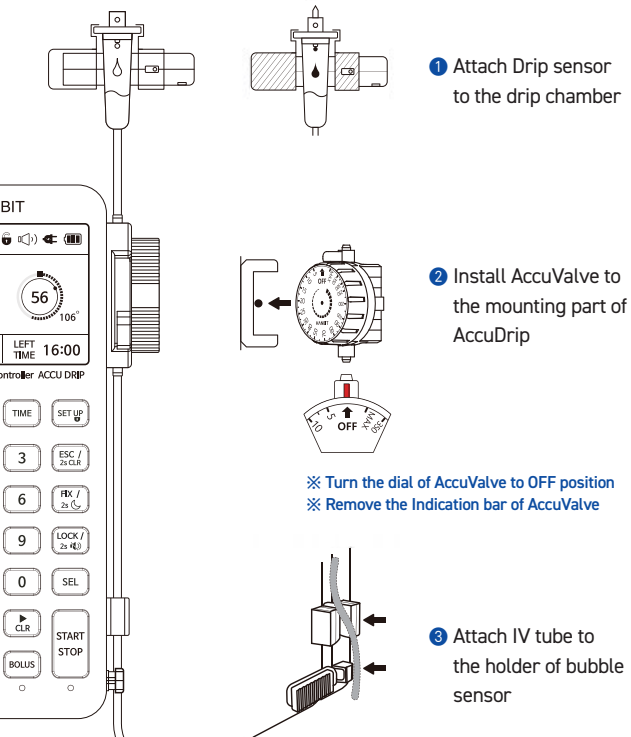

SEQUENCE OF OPERATION



Providing people with the value of healthy life



HANBIT

(35240) #1026, Hyundai Itel, 133, Dunsan-ro, Seo-gu, Daejeon
T. 042-488-2200 ivic@hanbitmd.com

HANBIT
www.hanbitmd.com

ACCU DRIP

- SAFE
- ACCURATE
- CONVENIENT



International patency New health technology Technically cooperated with Korea Aerospace Research Institute



HANBIT

Innovative Solution for Infusion

AccuDrip is a device that automatically injects fluids through the monitoring of the drip sensor and control over the flow control valve, AccuValve, allowing the device to infuse under constant gravity.

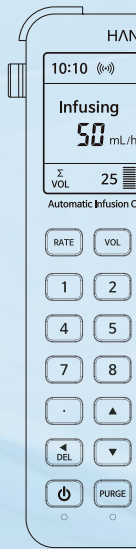

STRENGTHS

SAFE

- Infusing under constant pressure lowers the risk of tissue injury by extravasation.
- No risk of free flow even when the IV line is detached from the device.

ACCURATE

- Maintains a stable flow rate of infusion from beginning to end with an error rate less than 3%.
- Not applying pressure on the tube eliminates the chance of IV tube deformation, maintaining a consistent flow.

CONVENIENT

- IV set is easy to attach and detach
- Small (1/6 to 1/3 size of Infusion pump) and lightweight (600g).
- Long battery life (24 hours) without power cord.
- User friendly interface shows the current flow rate as well as delivered volume and remaining time.

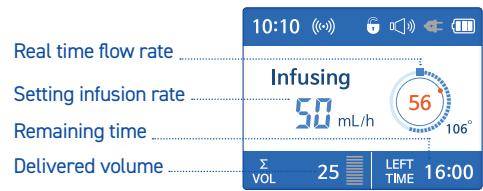

SPECIAL FEATURES

Extravasation monitor mode

- Alerts when extravasation is suspected for ICU patients.

Voice feedback

- Prevent human error by reading entered prescription aloud.

Real-time monitoring

- Alerts when detecting abnormal drip interval.

User-friendly interface

- Displays real time flow rate, delivered volume and remaining time.

Fix mode

- Fixes valve control with current flow rate when moving patients.

Sleep mode only in Fix mode

- Reduces display brightness for patients' comfortable sleep. only with Fix mode

PRODUCT SPECIFICATION

Product name	AccuDrip
Model name	IC-A
Size	78mm(Width)x162mm(Length)x64mm (Thickness)
Input range of Infusion rate	1~999 mL/h
Input range of Volume	1~9999 mL
Input range of Time	1 min ~ 99 hours 59 min
Control range	±3%, ±5%
Clinical alarm	Abnormalities during infusion, End of infusion, No drop detection, Air bubble detection, Low battery
Power and battery	100~240 VAC, 50/60Hz, 0.5~1.2A (Nickel hydrogen, 4.8V, 4200mA)
Battery life	24 hours
Waterproof grade	IPX2
Type and grade of protection	Grade 1, Internal power supply, BF type
Dedicated IV set	AccuValve IV set

• Extravasation, caused by the catheter dislodging blood vessels, occurs at a higher rate than reported in actual clinical practice. Since conventional infusion pumps compress the tube and inject fluid under forced pressure, there is a high risk of tissue damage when extravasation occurs. Therefore, various literature and guidelines recommend that peripheral vesicant drugs such as antineoplastic agents should be administered by gravity drip, not by infusion pump. However, if precise flow rate control is required, there is currently no suitable device other than the conventional infusion pump.

• In this respect, AccuDrip's infusion system regulated by flow control valve is the world's only infusion device capable of precise infusion control using gravity drip. It does not infuse fluid over the tissue pressure limit, and the monitoring of drip sensor analyzes the drip interval to turn on an alarm, which decreases the risk of tissue injury by extravasation.